

Artiglio Master Code Standard & Optional

STANDARD

A) Locking Pistol	No. 5-103528
B) Spacer	No. 5-104690
C) Mini Plastic Cone (2")	No. 462414B
D) Small Plastic Cone (3")	No. 462415A
E) Universal Code (4.7")	No. 4-102353A
F) Yellow Plastic Cone Cover	No. 461668C
G) Medium Cone (5.7")	No. 4-102346
H) Universal Grease Bucket Holder	No. 5-101236
I) Light Truck Kit	No. 8-11100086
<i>Large Plastic Cone (7.3")</i>	<i>No. 4-103233A</i>
<i>Light Truck Spacer</i>	<i>No. 9005-100690</i>
J) Bead Clip f/RFT	No. 801262417
K) Inflation Kit	No. 801260961
L) Articulating Arm	Standard
M) Yellow Plastic MD head insert (each)	No. 4-107970
N) Yellow Plastic protection tip (for pistol)	No. 461560

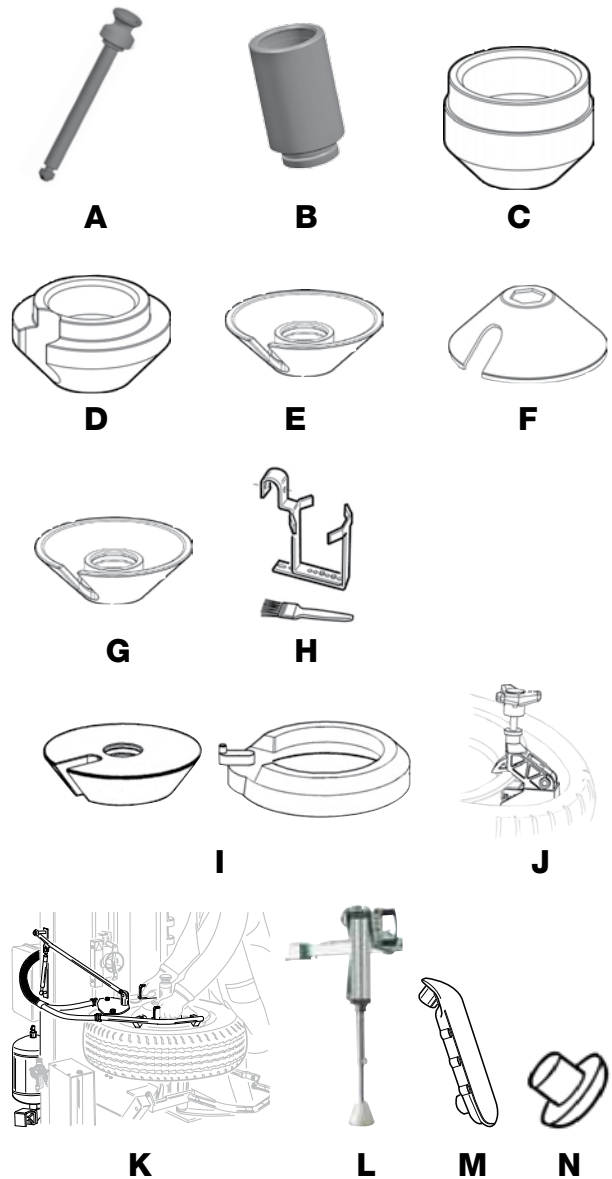

OPTIONAL

A) Reverse Mount Adapter	No. 8-11100073
B) Clad Wheel Adapter f/AM26	No. 8-11100087
C) Spaser Set (6 ea)	No. 8-11100046

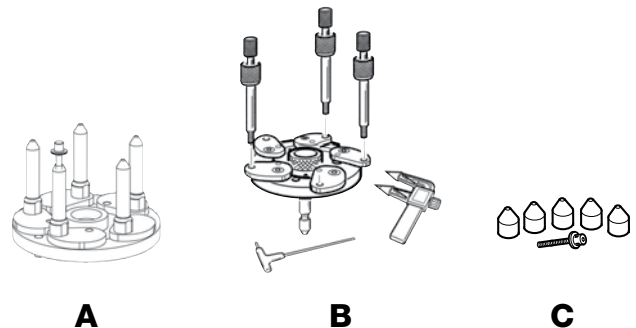

Note: Because of ongoing product improvements, it is necessary to have the model and serial number available when inquiring about accessories or placing an order.

AM26 Artiglio Master Standard & Optional

STANDARD

A) Locking Pistol	No. 5-100683C
B) Spacer	No. 263436A
C) Mini Plastic Cone (2")	No. 462414B
D) Small Plastic Cone (3")	No. 462415B
E) Universal Cone (4.7")	No. 4-102353A
F) Yellow Plastic Cone Cover	No. 461668C
G) Medium Cone (5.7")	No. 4-102346
H) Universal Grease Bucket Holder	No. 5-101236
I) Light Truck Kit	No. 8-11100037
<i>Large Plastic Cone (7.3")</i>	<i>No. 461667E</i>
<i>Light Truck Spacer</i>	<i>No. 9005-100690</i>
J) Bead Clip f/RFT	No. 801262417
K) Inflation Kit	No. 801260961
L) Yellow Insert for MD Head	No. 461489A

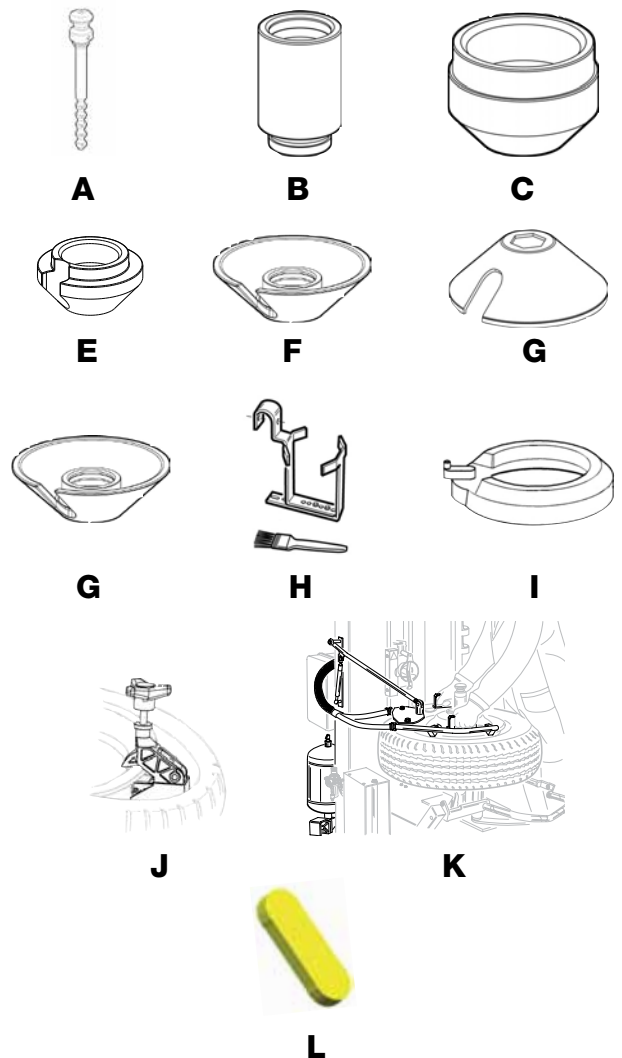

OPTIONAL

A) Articulating Arm	No. 801263408
B) Reverse Mount Adapter	No. 8-11100073
C) Clad Wheel Adapter f/AM26	No. 8-11100038
D) Spacer Set (6 ea)	No. 8-11100046
E) PAX Kit	No. 801260860

Note: Because of ongoing product improvements, it is necessary to have the model and serial number available when inquiring about accessories or placing an order.

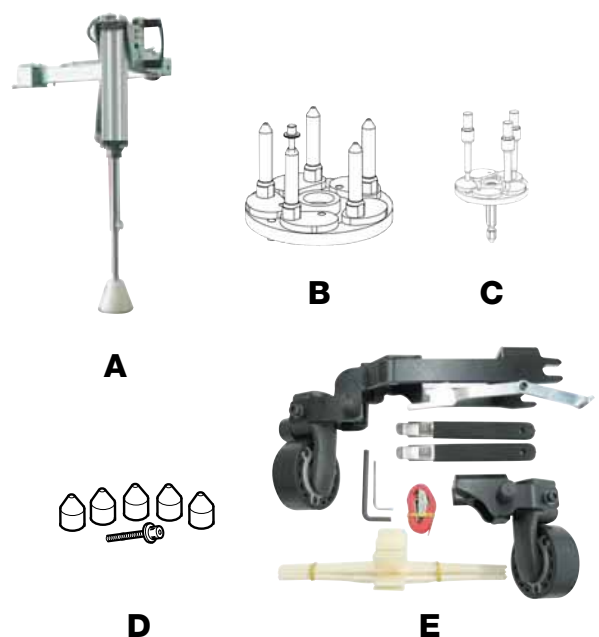

AM500/50 Standard & Optional

STANDARD

A) Locking Pistol	No. 5-101197B
B) Spacer	No. 5-102722
C) Mini Plastic Cone (2")	No. 4-103235C
D) Small Plastic Cone (3")	No. 4-103234B
E) Universal Cone (4.7")	No. 4-103230B
F) Yellow Plastic Cone Cover	No. 4-103232A
G) Medium Cone (5.7")	No. 4-103229A
H) Universal Grease Bucket Holder	No. 5-101236
I) Light Truck Kit	No. 8-11100086
<i>Large Plastic Cone (7.3")</i>	<i>No. 103233A</i>
<i>Light Truck Spacer</i>	<i>No. 9005-100690</i>
J) Bead Clip f/RFT	No. 801262417
K) Inflation Kit	No. 801260961
L) Red Helper Bar	No. 4-405496
M) Finger Insert for MD Head	No. 4-103502B
N) Triangle Insert for MD Head	No. 4-106611

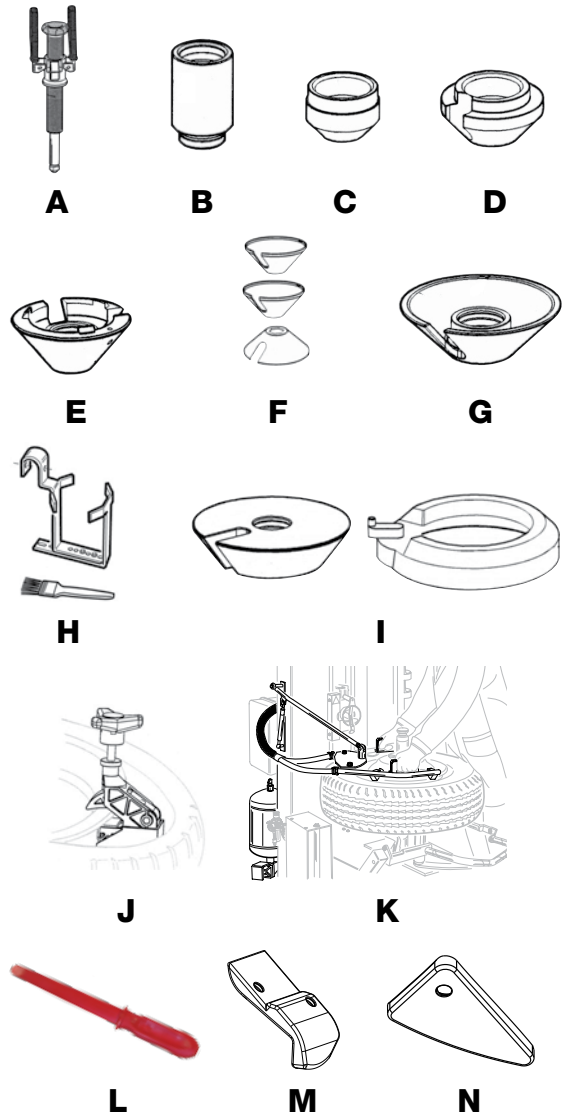

OPTIONAL

A) Articulating Arm f/AM500	No. 8-11100221
A) Articulating Arm f/AM50	No. 8-11100097
B) Reverse Mount Adapter	No. 8-11100073
C) Clad Wheel Adapter	No. 8-11100087
D) Spacer Set (6 ea)	No. 8-11100046
E) PAX Kit	No. 8-11100118
F) Yellow Protection Kit	No. 5-102468
(10) Finger Insert	<i>No. 4-103502</i>
(5) Triangle Insert	<i>No. 4-106611</i>
(2) Plastic Cone Cover	<i>No. 103232A</i>
Insert Screw	<i>No. 2-03438</i>

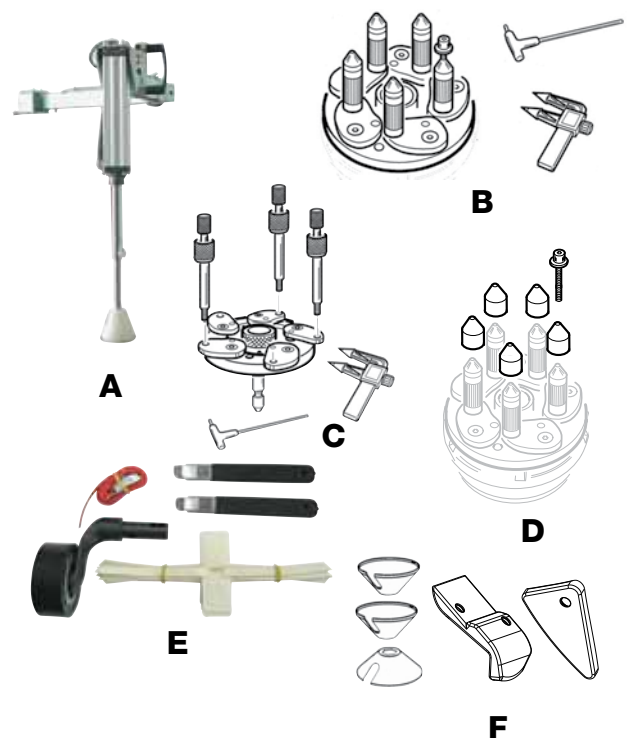

Note: Because of ongoing product improvements, it is necessary to have the model and serial number available when inquiring about accessories or placing an order.

Rim Clamp Models

STANDARD

- | | |
|---|----------------|
| A) Pry Bar | No. 4-108275 |
| B) Yellow Inner Jaw Protector | No. 8-11100108 |
| C) Yellow Outer Jaw Protector | No. 8-11100109 |
| D) Yellow Plastic Insert for MD Head (body) (set of 10) | No. 8-11100006 |
| E) Yellow Plastic Insert for MD Head (tail) (set of 10) | No. 8-11100107 |
| F) Yellow Plastic Bead Breaker Cover | No. 8-11100105 |
| G) Yellow Plastic Pry Bar Cover | No. 8-11100104 |

“LL” MODEL ONLY

NO PRY BAR!

- | | |
|--------------------------------|--------------|
| A) Red Helper Bar | No. 4-405496 |
| B) Finger Insert for MD Head | No. 4-103502 |
| C) Triangle Insert for MD Head | No. 4-106611 |

OPTIONAL

- | | |
|---|----------------|
| A) 4" Jaw Adapters | No. 801263517 |
| B) 2" Offset MD Head Shaft (A2024TI) | No. 8-11100015 |
| C) WL60 Wheel Lift | No. 8-11600004 |
| D) MD Head (Replacement) | No. 258458 |
| E) Plastic MD Head Kit
(includes mounting flange & hardware) | No. 801250309 |
| F) Plastic MD Head Only | No. 450310 |
| G) Bead Depressing Lever (9220/9824) | No. 801242834 |
| H) Bead Clamp | No. 801435685 |
| I) Bead Clamp for Contoured Wheels | No. 801261910 |
| J) Yellow Plastic Bead Breaker Cover (set of 6) | No. 8-11100105 |
| K) Yellow Plastic Pry Bar Cover (set of 6) | No. 8-11100104 |
| L) Motorcycle Jaw Adapters | No. 801258650 |
| M) Motorcycle Bead Breaker Blade Attachment | No. 801260402 |
| N) SP 2300 Articulating Power Unit | |
| <i>Power unit</i> | No. 8-11100310 |
| <i>Mounting bracket</i> | No. 8-11100351 |
| <i>Mobile arm</i> | No. 8-11100306 |
| O) SP2000 Power Unit (Tilt back models only) | |
| <i>SP2000 Rotary Bead Breaker</i> | No. 801255567 |
| <i>SP2000 Mounting Kit</i> | No. 8-11100026 |
| P) PU1500 Power Unit | |
| <i>PU1500 Main Unit</i> | No. 8-11100027 |
| <i>PU1500 Arm Assembly</i> | No. 8-11100030 |
| <i>PU1500 Mounting Kit</i> | No. 8-11100031 |
| Q) BPT Articulating Arm | No. 8-11100100 |

